

SECTION A-A

FOR DETAILS OF SOCKET WITH IPC FALNGE AND PLUG FITTED SEE SHEET 2.

REF	ITEM NO.	DESCRIPTION	QTY
1	MC124996	RESTRAINED SOCKET BODY.	1
2	MC50849E	INSULATOR	1
3	MC50491/A	EARTH SCRAPER ASSEMBLY	1
4	MC50054	WITHDRAWAL SPINDLE ASSEMBLY	1
5	MC50250	SPIGOT	1
6	MC50492/A	EARTH PLATE ASSEMBLY	1
7	MC124772	EARTH PIN	1
8	MC50500	INTERFACE SEAL	1
9	GPC13-16	SOCKET SET SCREW - M8 x 25	1
10	GPC44-38	O RING	1
11	GPC44-42	O RING	1
12	GPC44-45	O RING	1
13	MC124863	SHROUDS	4
14	MC50098	EARTH SCRAPER RETAINING WASHER	2
15	GPC12-5	SKT.HD.CAP SCREW - M5 x 16	2
16	MC50488	MAINS CONTACT PIN SPACER	3
17	MC50489	PILOT & AUX.PIN SPACER	1
18	SEE TABLE	MAINS CONTACT PIN	3
19	MC50252	PILOT CONTACT PIN	1
20	MC50277	AUXILIARY CONTACT PIN	2

MAINS CONTACT PIN VARIANTS			
CONDUCTOR	GRUBSCREW		CRIMPED.
	MAINS		MAINS
6mm ²	-		
16mm ²	MC50251A		-
25mm ²	MC50251B		-
35mm ²	MC50251C		-
50mm ²	MC50251D		MC50721
70mm ²	MC50251E		MC50630
95mm ²	MC50251F		MC50608
120mm ²	MC50251G		MC50738

DRAWING No.	ISSUE No.
CP277	1

CERTIFICATE RELATED DRAWING
NO MODIFICATIONS PERMITTED WITHOUT THE APPROVAL OF THE TECHNICAL MANAGER

DO NOT SCALE

DIMENSIONS IN MILLIMETRES (mm)
MAXIMUM MACHINED SURFACE
TEXTURE um Ra 3.2
MACHINE WHERE MARKED THUS ✓
ANGULAR TOLERANCES ±1/2°

DIMENSIONAL TOLERANCES UNLESS OTHERWISE STATED
UPTO 6 ±0.1
OVER 6 UPTO 30 ±0.2
OVER 30 UPTO 100 ±0.3
OVER 100 UPTO 300 ±0.5
OVER 300 ±0.8

TEST No.	PROCESS No.
200	---
DRAWN	HD
DATE	16/6/04
CHECKED	16/6/04 EJ
APPROVED	16/6/04 HD
SCALE	3:8

DCR	DRN	24/7/12	AER
CHK	24/7/12	AER	APP 24/7/12
RE-DRAWN.			

TYPE 530SA DUAL VOLTAGE RESTRAINED SOCKET - 500A 1100/3300V

Victor Victor Products Limited
Unit 3A, Tyne Dock East Side,
Port of Tyne, South Shields,
Tyne and Wear, NE33 5SQ,
United Kingdom.

DRAWING No.	ISSUE No.
SHEET 1 OF 2	
CP277	1

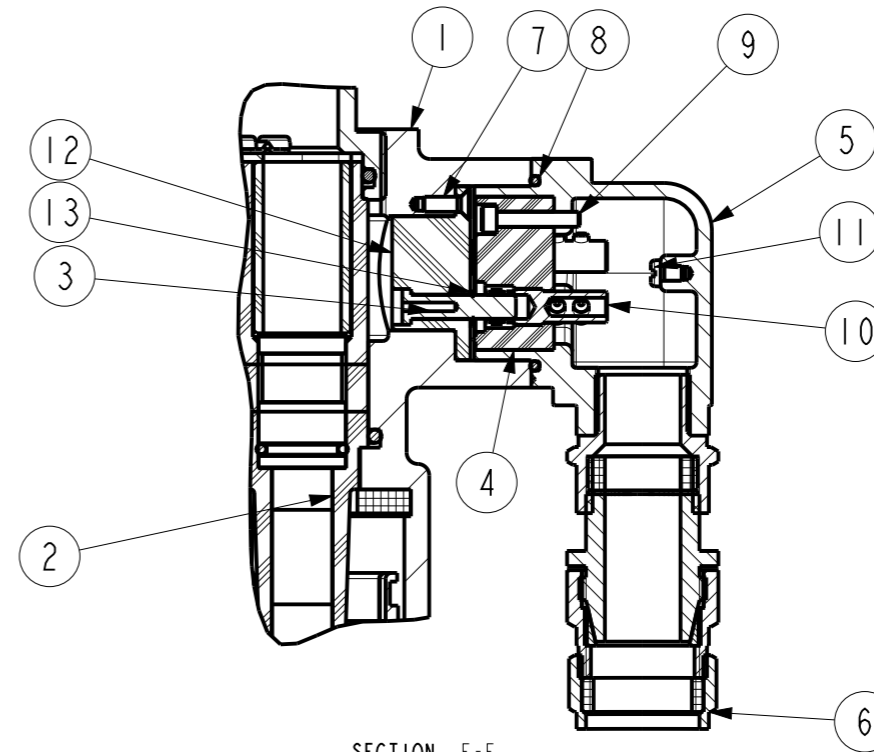
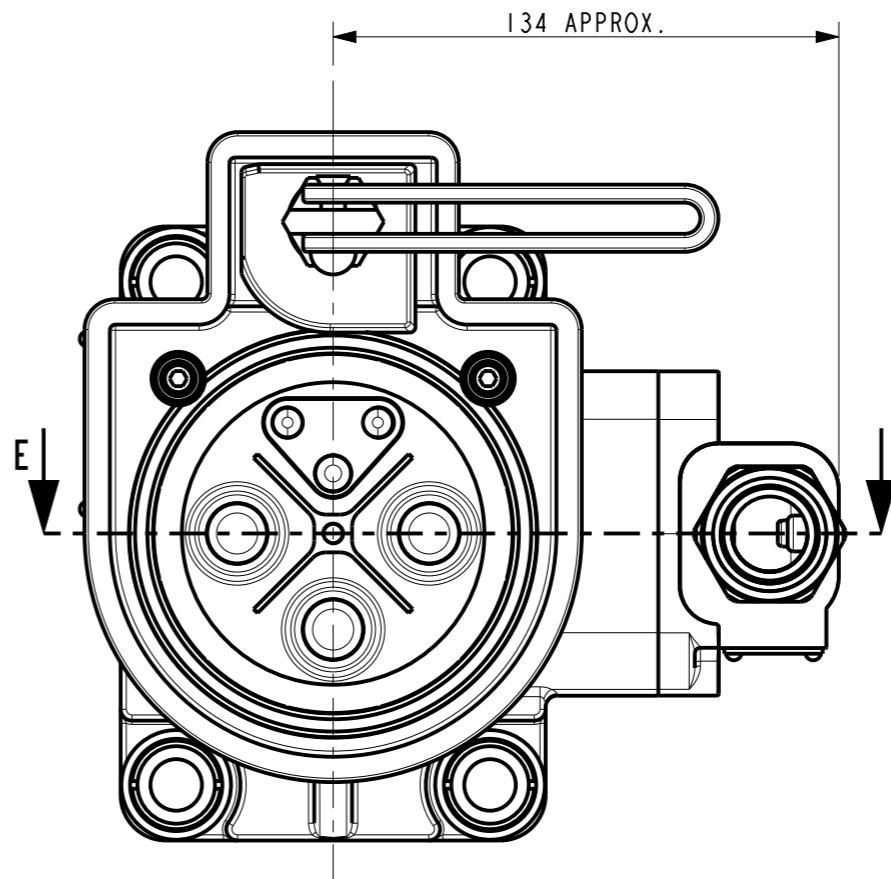
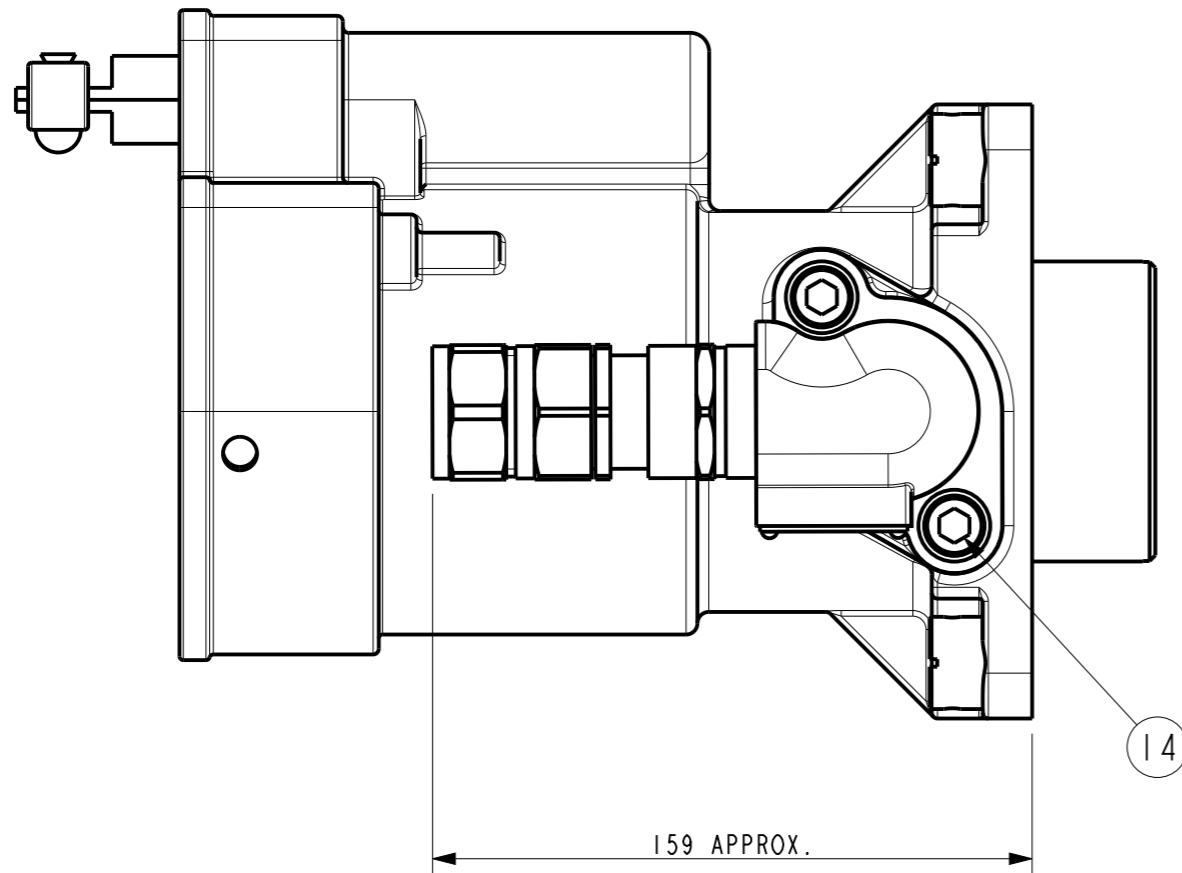

SECTION E-E

FOR ALL OTHER DETAILS REFER TO SHEET 1.

REF	ITEM NO.	DESCRIPTION	QTY
1	MC124997	RESTRAINED SOCKET BODY - IPC	1
2	MC50676RE	INSULATOR	1
3	MC124797	IPC PIN	3
4	MC50006	A63 PLUG INSULATOR	1
5	MC924960	A63 PLUG BODY	1
6	MGEIFTS25	GROUP 1 CERTIFIED GLAND	1
7	GPC13-19	SCKT. HD. C'SUNK SCREW - M4 x 10	3
8	GPC44-27	O RING	1
9	GP218209X	SOCKET HD. CAP SCREW - M4 x 22	1
10	MC50011	CONTACT TUBE - A63 PLUG	3
11	GPC216049	CHEESE HEAD SCREW - M4 x 6	1
12	MC124798	IPC INSULATOR	1
13	GPC21-4	EXTERNAL CIRCLIP	3
14	GPC12-7	SCKT. HD. CAP SCREW - M10 x 16	2
15	GPC12-5	SCKT.HD.CAP SCREW - M5 x 16	2

DRAWING No.	ISSUE No.
CP277	0

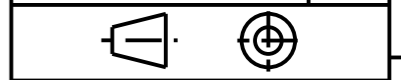

CERTIFICATE RELATED DRAWING

NO MODIFICATIONS PERMITTED WITHOUT THE APPROVAL OF THE TECHNICAL MANAGER

DO NOT SCALE

DIMENSIONS IN MILLIMETRES (mm)
 MAXIMUM MACHINED SURFACE
 TEXTURE um Ra 3.2
 MACHINE WHERE MARKED THUS ✓

ANGULAR TOLERANCES ±1/2°

DIMENSIONAL TOLERANCES UNLESS OTHERWISE STATED

UPTO 6	±0.1
OVER 6 UPTO 30	±0.2
OVER 30 UPTO 100	±0.3
OVER 100 UPTO 300	±0.5
OVER 300	±0.8

TEST No.	PROCESS No.
200	---

DRAWN AER

DATE 24/7/12

CHECKED 24/7/12 AER

APPROVED 24/7/12 AER

SCALE 1:1

DCR	DRN	24/7/12	AER
CHK	APP	24/7/12	AER

SHEET 2 INTRODUCED.

TYPE 53RSA DUAL VOLTAGE RESTRAINED SOCKET WITH IPC PLUG TYPE A63

Victor

Victor Products Limited
 Unit 3A, Tyne Dock East Side,
 Port of Tyne, South Shields,
 Tyne and Wear, NE33 5SQ,
 United Kingdom.

DRAWING No.	ISSUE No.
SHEET 2 OF 2	

CP277

0