

SECTION A-A

SECTION D-D

REF. No.	ITEM No.	DESCRIPTION	No. OFF
1	280012A	CIRCLIP	1
2	123002E	INSULATOR - FLP	1
3	123003	INSULATOR CAP	1
4	123891	'O' RING	1
5	124672	MAINS PIN SEAL	3
6	123004	GASKET	1
7	124140	SEAL RING	1
8	921011	SHROUD ASSEMBLY	1
9	923016W	PILOT CONTACT PIN - FLP	1
10	924671-	MAINS CONTACT PIN ASSEMBLY - FLP	3
11	925049	A44SR SOCKET BODY ASSEMBLY - FLP	1

SEE SHEET 2 FOR PLUG DETAILS.  
 SEE SHEET 3 FOR SOCKET COUPLER DETAILS.  
 SEE SHEET 4 FOR INTERFACE DETAILS.

DRAWING No.	ISSUE No.
CP281	3

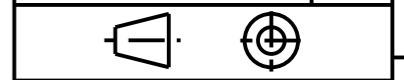

CERTIFICATE RELATED DRAWING

NO MODIFICATIONS PERMITTED WITHOUT THE APPROVAL OF THE TECHNICAL MANAGER

DO NOT SCALE

DIMENSIONS IN MILLIMETRES (mm)  
 MAXIMUM MACHINED SURFACE  
 TEXTURE  $\mu\text{m Ra } 3.2$   
 MACHINE WHERE MARKED THUS ✓

ANGULAR TOLERANCES  $\pm 1/2^\circ$

DIMENSIONAL TOLERANCES UNLESS OTHERWISE STATED  
 UPTO 6  $\pm 0.1$   
 OVER 6 UPTO 30  $\pm 0.2$   
 OVER 30 UPTO 100  $\pm 0.3$   
 OVER 100 UPTO 300  $\pm 0.5$   
 OVER 300  $\pm 0.8$

TEST No.	PROCESS No.
200	---

DRAWN AER

DATE 3/8/09

CHECKED 3/8/09 AER

APPROVED 3/8/09 AER

SCALE 1:2

2	DCR 2009	DRN	3/8/09	AER	3	DCR	DRN	8/7/10	AER		
	CHK	3/8/09	AER	APP		3/8/09	AER	CHK	8/7/10	AER	APP

REDRAWN.

SECTION 'D-D' ADDED

TYPE A44SR RESTRAINED SOCKET 100A 650/1300V

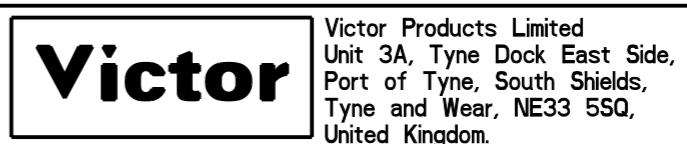

DRAWING No.	ISSUE No.
SHEET 1 OF 4	
CP281	3

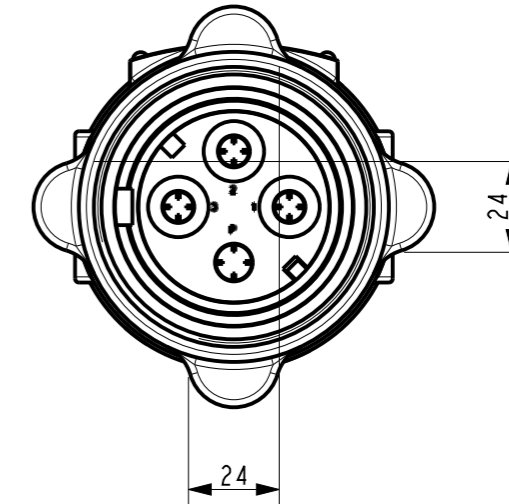
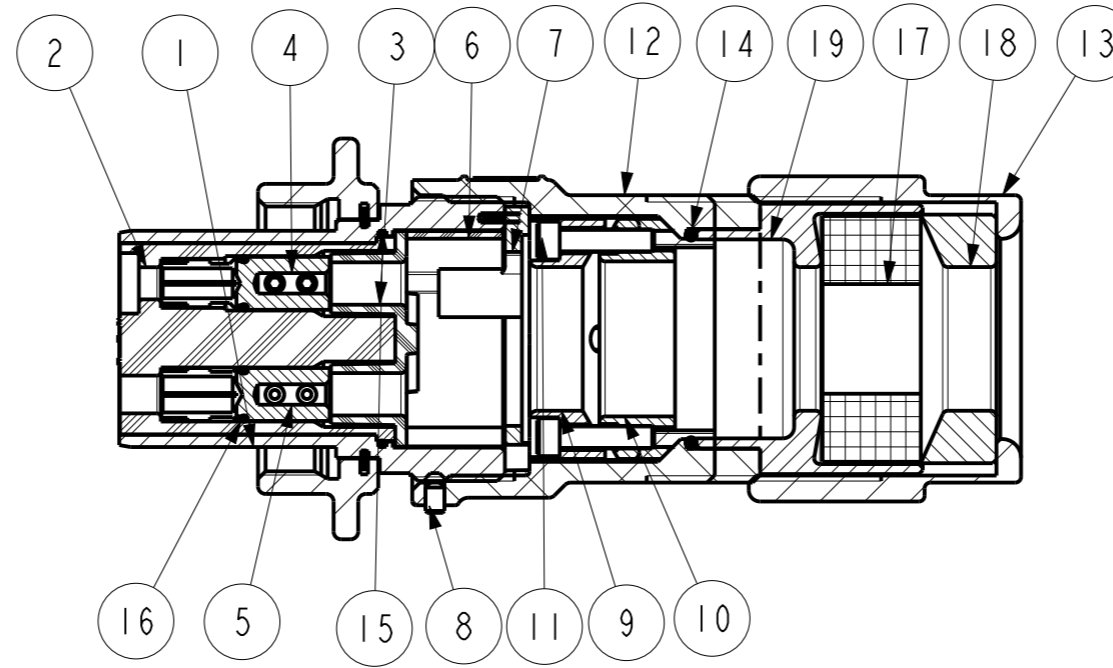
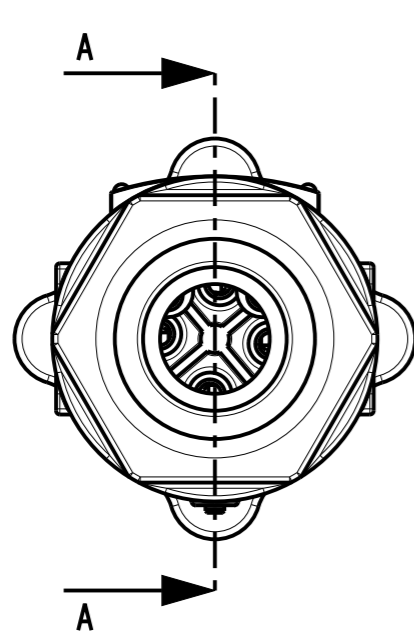

SECTION A-A

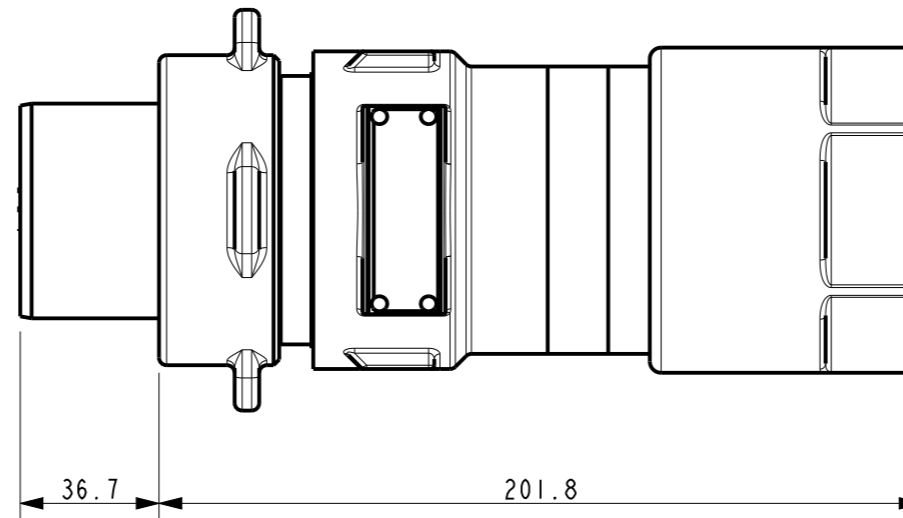

REF. No.	ITEM No.	DESCRIPTION	No. OFF
1	924445	RESTRAINED PLUG BARREL ASSEMBLY	1
2	123001A	PLUG INSULATOR	1
3	123003	INSULATOR CAP	1
4	923007W	MAINS CONTACT TUBE - 16mm <sup>2</sup>	3
5	923008W	PILOT CONTACT TUBE - 16mm <sup>2</sup>	1
6	123013	DISTANCE PIECE	1
7	923006	SCREEN CLAMP ASSEMBLY	1
8	227010S	PLUG BARREL GRUBSCREW	1
9	123031	ARMOUR CLAMP SEAT	1
10	123022	ARMOUR CLAMP	1
11	218159A	ARMOUR CLAMP SCREWS	4
12	923019R	RESTRAINED PLUG BODY ASSEMBLY	1
13	124422	GLAND NUT	1
14	124136	'O' RING	1
15	124133	'O' RING	1
16	124132	'O' RING	4
17	124423-	CABLE SEALING RING - SEE NOTE	1
18	124427-	CLAMPING WASHER - SEE NOTE	1
19	124426-	CABLE SEALING RING BODY - SEE NOTE	1

A SELECTION OF CABLE SEALING RINGS, CLAMP WASHERS AND CLAMP RING BODIES ARE AVAILABLE TO COVER CABLE SIZES 17 - 52mm DIA.

SEE SHEET 1 FOR SOCKET DETAILS.  
SEE SHEET 3 FOR SOCKET COUPLER DETAILS.  
SEE SHEET 4 FOR INTERFACE DETAILS.

DRAWING No.	ISSUE No.
CP281	2

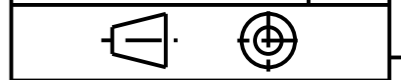

CERTIFICATE RELATED DRAWING

NO MODIFICATIONS PERMITTED WITHOUT THE APPROVAL OF THE TECHNICAL MANAGER

DO NOT SCALE

DIMENSIONS IN MILLIMETRES (mm)  
MAXIMUM MACHINED SURFACE  
TEXTURE  $\mu\text{m Ra } 3.2$   
MACHINE WHERE MARKED THUS

DIMENSIONAL TOLERANCES UNLESS OTHERWISE STATED

TEST No.	PROCESS No.
200	---
DRAWN	AER
DATE	3/8/09
CHECKED	3/8/09 AER
APPROVED	3/8/09 AER
SCALE	1:2

2	DCR 2009	DRN	3/8/09	AER	
	CHK	3/8/09	AER APP	3/8/09	AER

DETAILS WERE SHOWN ON CP282.

TYPE A44PR RESTRAINED PLUG - 100A 650/1100V

**Victor** Victor Products Limited  
Unit 3A, Tyne Dock East Side,  
Port of Tyne, South Shields,  
Tyne and Wear, NE33 5SQ,  
United Kingdom.

DRAWING No.	ISSUE No.
SHEET 2 OF 4	
CP281	2

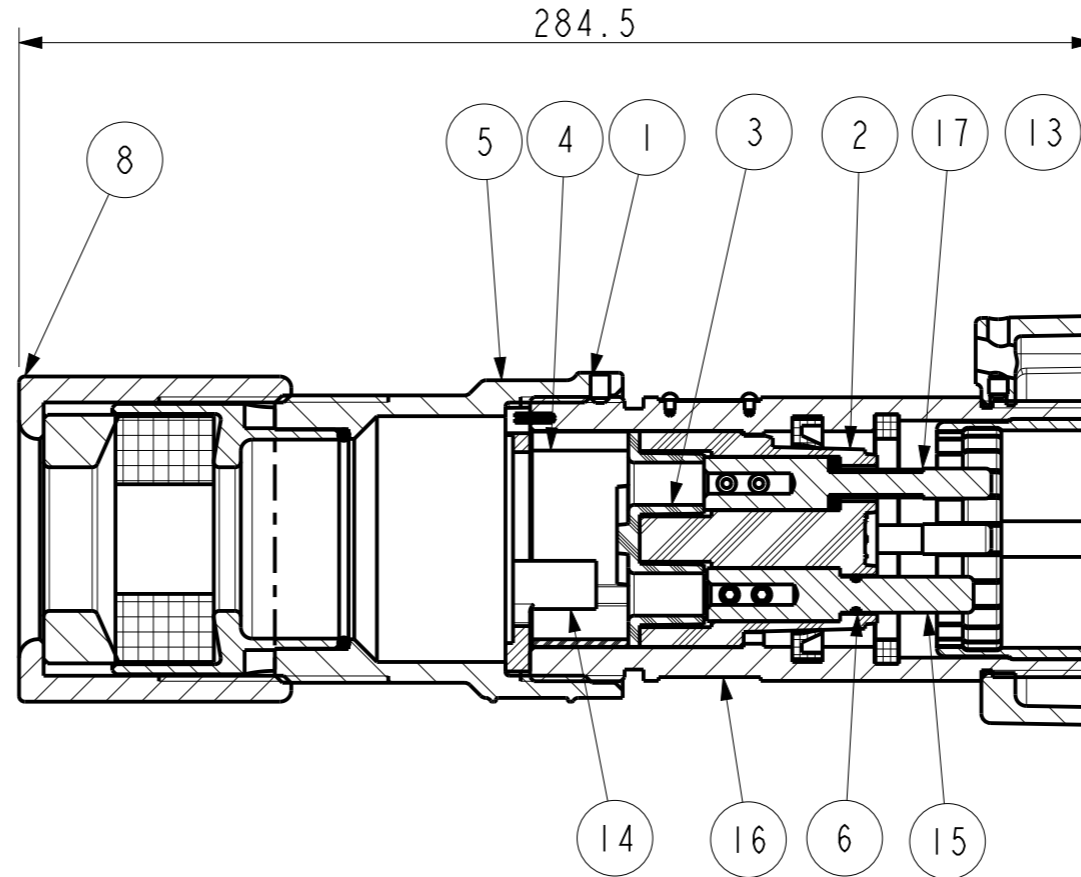
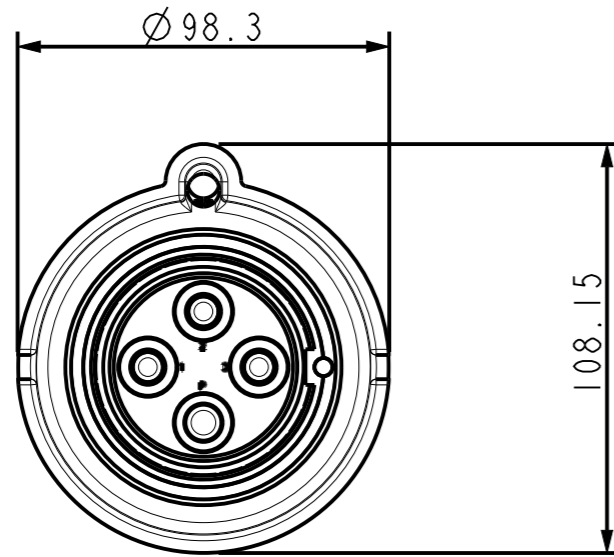

SECTION A-A

REF. No.	ITEM No.	DESCRIPTION	No. OFF
1	227010S	PLUG BODY RETAINING SCREW	1
2	123002E	SOCKET INSULATOR - FLP	1
3	123003	INSULATOR CAP	1
4	123013	DISTANCE PIECE	1
5	123019W	PLUG BODY	1
6	123891	O-RING	1
7	124136	O-RING	1
8	124422	GLAND NUT	1
9	124423-	CABLE SEALING RING - SEE NOTE	1
10	124426-	CABLE SEALING RING BODY - SEE NOTE	1
11	124427-	CLAMPING WASHER - SEE NOTE	1
12	124672	MAINS PIN SEAL	3
13	921011	SHROUD ASSEMBLY	1
14	923006	SCREEN CLAMP ASSEMBLY	1
15	923016W	AUXILIARY CONTACT PIN	1
16	924477	COUPLER SOCKET BODY ASSEMBLY	1
17	924671	MAINS CONTACT PIN	3

SEE SHEET 1 FOR SOCKET DETAILS.  
 SEE SHEET 2 FOR PLUG DETAILS.  
 SEE SHEET 4 FOR INTERFACE DETAILS.

DRAWING No.	ISSUE No.
CP281	1



CERTIFICATE RELATED DRAWING

NO MODIFICATIONS PERMITTED WITHOUT THE APPROVAL OF THE TECHNICAL MANAGER

DO NOT SCALE

DIMENSIONS IN MILLIMETRES (mm)  
 MAXIMUM MACHINED SURFACE  
 TEXTURE  $\mu\text{m Ra } 3.2$   
 MACHINE WHERE MARKED THUS

ANGULAR TOLERANCES  $\pm 1/2^\circ$

DIMENSIONAL TOLERANCES UNLESS OTHERWISE STATED

UPTO 6	$\pm 0.1$
OVER 6 UPTO 30	$\pm 0.2$
OVER 30 UPTO 100	$\pm 0.3$
OVER 100 UPTO 300	$\pm 0.5$
OVER 300	$\pm 0.8$

TEST No.	PROCESS No.
200	---

DRAWN	AER
-------	-----

DATE	8/7/10
------	--------

CHECKED	
---------	--

APPROVED	
----------	--

SCALE	1:2
-------	-----

DCR	DRN	8/7/10	AER
CHK	8/7/10	AER	APP
		8/7/10	AER

DRAWING INTRODUCED.

TYPE A44SCR RESTRAINED SOCKET  
 COUPLER 100A 650/1100V

**Victor**  
 Victor Products Limited  
 Unit 3A, Tyne Dock East Side,  
 Port of Tyne, South Shields,  
 Tyne and Wear, NE33 5SQ,  
 United Kingdom.

DRAWING No.	ISSUE No.
SHEET 3 OF 4	
CP281	1

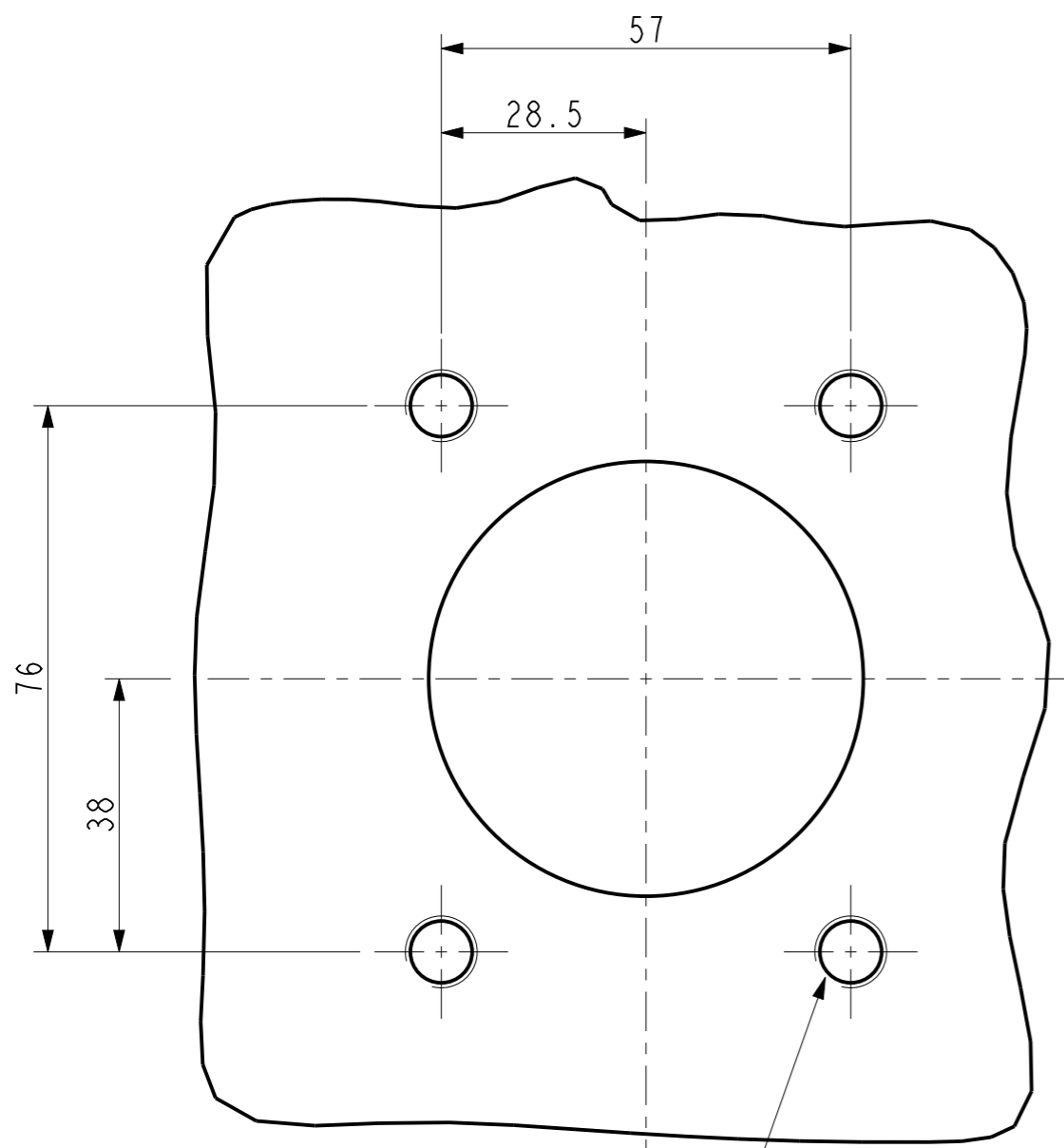

4 HOLES AS SHOWN  
M10 x 1.5p - 6H WITH  
A MINIMUM LENGTH OF 18  
FULL LENGTH THREADS.

SEE SHEET 1 FOR SOCKET DETAILS.  
SEE SHEET 2 FOR PLUG DETAILS.  
SEE SHEET 3 FOR PLUG COUPLER DETAILS.

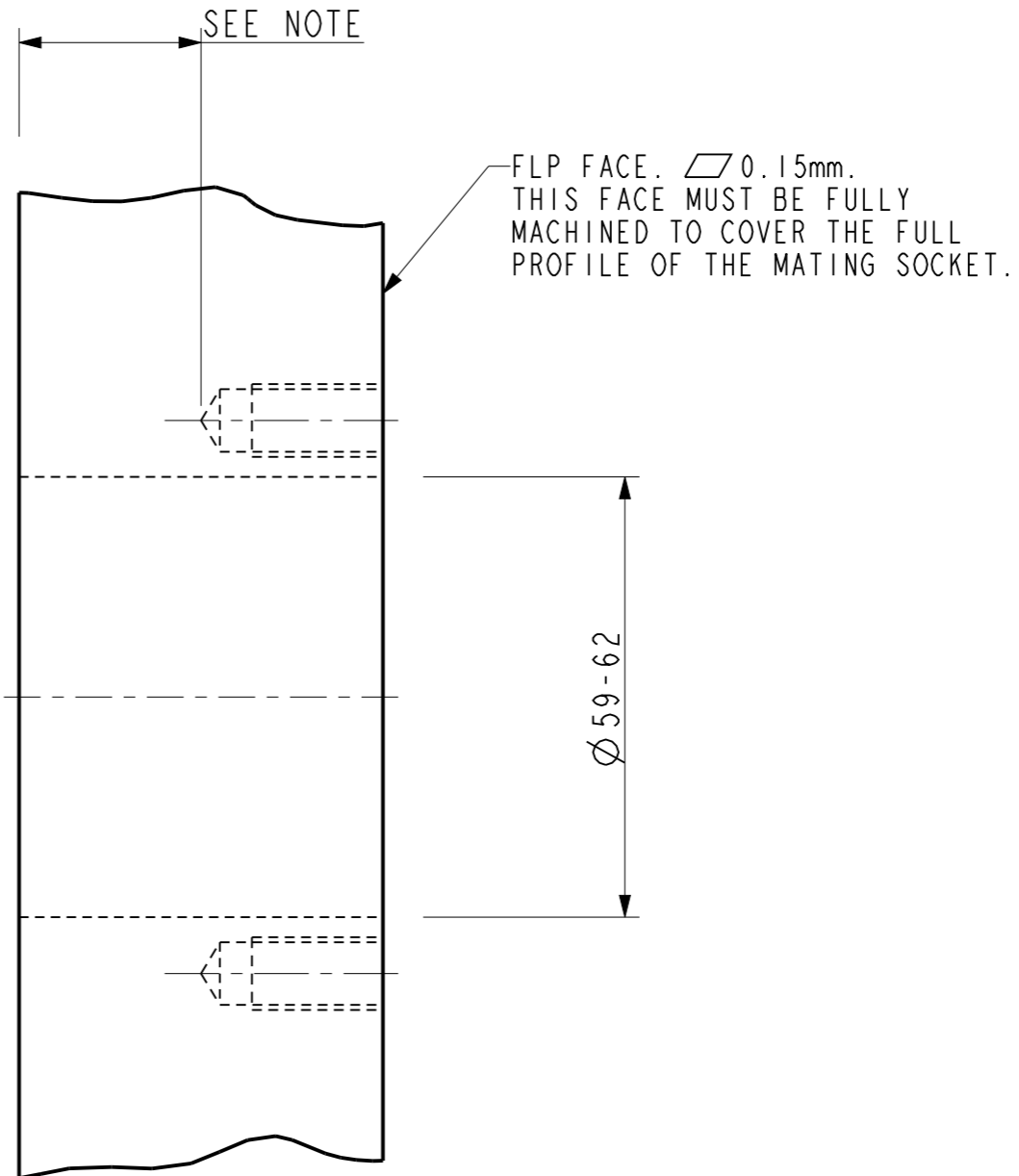

NOTE: THERE MUST BE SUFFICIENT WALL THICKNESS BEHIND THE DRILL POINT TO SATISFY THE NOTIFIED CERTIFICATION AUTHORITY.

DRAWING No.	ISSUE No.
CP281	1



CERTIFICATE RELATED DRAWING

NO MODIFICATIONS PERMITTED WITHOUT THE APPROVAL OF THE TECHNICAL MANAGER

DO NOT SCALE

DIMENSIONS IN MILLIMETRES (mm)  
MAXIMUM MACHINED SURFACE  
TEXTURE  $\mu\text{m Ra } 3.2$   
MACHINE WHERE MARKED THUS

DIMENSIONAL TOLERANCES UNLESS OTHERWISE STATED

TEST No.	PROCESS No.
200	---
DRAWN	AER
DATE	3/8/09
CHECKED	3/8/09 AER
APPROVED	3/8/09 AER
SCALE	1:2

DCR 2009	DRN	3/8/09	AER
CHK	3/8/09	AER APP	3/8/09

WAS SHOWN ON SHEET 2.

TYPE A44 SOCKET INTERFACE DETAILS.

**Victor**

Victor Products Limited  
Unit 3A, Tyne Dock East Side,  
Port of Tyne, South Shields,  
Tyne and Wear, NE33 5SQ,  
United Kingdom.

DRAWING No.	ISSUE No.
SHEET 4 OF 4	
CP281	1